

Service Fixtures

Ensuring laboratory efficiency









Fast & Professional

About our Service Fixtures

Service fixtures in laboratories provide essential utilities such as gas, water, and electricity to support various scientific activities. They ensure a safe and controlled environment by offering precise and reliable access to these critical resources. By integrating advanced service fixtures, laboratories can enhance operational efficiency, reduce downtime, and maintain high standards of research and experimentation.

Products

-  **Faucets**
-  **Gas Turrets**
-  **Electrical/Data Fixtures**
-  **Quick Connects**
-  **Eye Washes**
-  **Safety Showers**



www.FENCOLABS.com

Find your solution today!



Toll-Free: 800.486.8484

SERVICE FIXTURES

VALVE SELECTION GUIDE

A wide selection of valves are available for use with laboratory gases. The selection of a valve for any particular application depends upon many factors, including the working pressure of the gas, the degree of metering or control desired, and the characteristics (including the corrosiveness) of the gas. This **Valve Selection Guide** is presented to assist in selecting the most appropriate valve for an application. However, care must be taken in selecting valves for gas service. In particular, reference must be made to applicable plumbing and piping codes, life safety standards and project specifications when selecting valves. (*Not all service types are included within this catalog, contact factory for information.)

	Fine Control Needle Valve	Standard Needle Valve	Needle Point Cock	Laboratory Ball Valve	Ground Key Cock
Construction	Needle Point	Needle Point	Needle Point	Ball Valve	Ground Key
Control	Precise Metering	Good Metering	Limited Metering	On/Off	On/Off
Material	Brass or St. Stl.	Brass or St. Stl.	Brass	Brass or St. Stl.	Brass
Handle	Four Arm	For Arm	Round Knurled	Lever	Lever
Test Pressure/Media	375 PSI/Nit	225 PSI/Nit	100 PSI/Nit	125 PSI/Nit	80 PSI/Ar
Max. Working Pressure	250 PSI	150 PSI	60 PSI	75 PSI	40 PSI
AGA/CGA Certification	-	-	-	Yes	-
ADA Compliant	-	-	-	Yes	-
Use with Pressure Regulator	Yes	-	-	-	-
Cleaned for High Purity Gas	Standard	When Ordered	When Ordered	When Ordered	-

Gas Compatibility by Service (Symbol):

Air (AIR)	Yes	Yes	Yes	Yes	Yes
Ammonia (NH3)	St. Stl. Only	St. Stl. Only	-	-	-
Acetylene (C2H2)	St. Stl. Only; 15 PSI max	St. Stl. Only; 15 PSI max	-	-	-
Argon (AR)	Yes	Yes	Yes	Yes	-
Butane (BUT)	Yes	Yes	Yes	Yes	-
Carbon Dioxide (CO2)	Yes	Yes	Yes	Yes	-
Carbon Monoxide (CO)	Yes	Yes	Yes	Yes	-
Compressed Air (CA)	Yes	Yes	Yes	Yes	Yes
Cylinder Gas (CYL GAS)	Yes	Yes	Yes	Yes	-
Gas (GAS)	Yes	Yes	Yes	Yes	Yes
Helium (HE)	Yes	Yes	Yes	Yes	-
High Vacuum (HI VAC)	Yes	Yes	Yes	Yes	Yes
Hydrogen (HYD)	Yes	Yes	Yes	Yes	-
Methane (CH4)	Yes	Yes	Yes	Yes	-
Nitrogen (NIT)	Yes	Yes	Yes	Yes	-
Oxygen (OXY)	Yes	(Specifically Clean)	(Specifically Clean)	(Specifically Clean)	-
Propane (PRO)	Yes	Yes	Yes	Yes	-
Special Gas (SG)	Yes	Yes	Yes	Yes	-
Vacuum (VAC)	Yes	Yes	Yes	Yes	Yes

SERVICE FIXTURES

INDEXING

WaterSaver faucets and valves are furnished with either a forged brass or molded nylon handle. Handles have a raised screw-on colored index button permitting visibility of index color from top and all sides. Color-coding and symbol standards for index buttons are as follows:

Standard Indexing	Index Color	Letter Color	Symbol
Air	Orange	Black	AIR
Carbon Dioxide	Pink	Black	CO2
Cold Water	Green	White	CW
Dionized Water	White	Black	DI
Distilled Water	White	Black	DW
Gas	Blue	White	GAS
Hot Water	Red	White	HW
Hydrogen	Pink	Black	HYD
Nitrogen	Brown	White	NIT
Oxygen	Lt. Green	Black	OXY
Steam	Black	White	STM
Vacuum	Yellow	Black	VAC

Other Indexing	Index Color	Letter Color	Symbol
Acetylene	Violet	White	C2H2
Acetylene	Violet	White	ACET
Ammonia	Lt. Green	Black	NH3
Argon	Violet	White	AR
Aspirator	Green	White	ASP
Butane	Lt. Blue	Black	BUT
Carbon Monoxide	Silver	Black	CO
Chilled Water	Green	White	CH WAT
Chilled Water Supply	Green	White	CHWS
Chilled Water Supply	Green	White	CWS
Chilled Water Return	Green	White	CHWR
Chilled Water Return	Green	White	CWR
Compressed Air	Orange	Black	CA
Cylinder Gas	Lt. Blue	Black	CYL GAS
Glycol Supply	Lt. Green	Black	GYL SUP
Glycol Return	Lt. Green	White	GYL RET
Helium	Black	Black	HE
High Vacuum	Yellow	Black	HI VAC
High Vacuum	Yellow	Black	HVAC

Other Indexing	Index Color	Letter Color	Symbol
Hydrogen	Pink	Black	H2
Hydrogen	Lt. Blue	Black	H
Hydrogen	Lt. Blue	Black	H2
Hydrogen	Lt. Blue	Black	HYD
Hydrogen Sulphite	Black	White	H2S
Ice Water	White	Black	IW
Industrial Cold Water	Green	White	ICW
Industrial Hot Water	Red	Red	IHW
Isobutene	Silver	Black	ISO
Lab Air	Orange	Black	LA
Lab Gas	Blue	White	LG
Lab Vacuum	Yellow	Black	LV
Low Vacuum	Yellow	Black	LO VAC
Low Vacuum	Yellow	Black	LVAC
Methane	Lt. Blue	Black	CH4
Natural Gas	Blue	White	NAT GAS
Nitrogen	Gray	Black	NIT
Nitrogen	Gray	Black	N2
Nitrogen	Brown	White	N
Nitrogen	Brown	Black	N2
Nitrogen (Cylinder)	Brown	White	NC
Nitrogen (Dewar)	Brown	White	ND
Nitrous Oxide	Lt. Green	Black	N2O
Oxygen	Lt. Green	Black	O2
Phosphorous	Tan	Black	P
Process Water	Green	White	PW
Propane	Pink	Black	PRO
Purified Water	White	Black	PW
Reverse Osmosis	White	Black	RO
Special Gas	Lt. Blue	Black	SG
Sulphur Dioxide	Tan	Black	SO2
Tempered Water	Green	White	TW

Note: Always specify when ordering fixtures.

SERVICE FIXTURES

ELECTRICAL FIXTURES







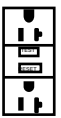

WaterSaver electrical boxes are UL-listed under standard UL514A, are machined for both standard and ground fault receptacles, and are furnished complete with grounding screws, 3/4" IPS mounting shank, locknut, and washer.

When complete assemblies are ordered, stainless steel face plates and receptacles are furnished. On **wrinkle black** and **satin aluminum pedestal boxes**, face plates are furnished with a satin (brushed) finish. On **polished aluminum pedestal boxes**, face plates are furnished with polished (bright) finish. Receptacles are black. Select finish from the following choices:

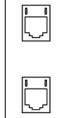
Wrinkle Black Epoxy: Cast aluminum boxes are powder coated with a wrinkle black epoxy coating. The coating has a matte finish which is abrasion and chemical resistant. (Standard finish) (Add suffix "**WS**")

Satin (Brushed) Aluminum: Cast aluminum boxes are polished to remove the rough cast surface. Boxes have an attractive brushed finish. (Add suffix "**SA**")

Polished (Bright) Aluminum: Cast aluminum boxes are polished and buffed to a chrome-like surface finish. Pedestal boxes thus have an appearance and finish to match the other service fixtures installed on the countertop. (Add suffix "**PB**")

Electric Boxes	Receptacles			
	 -33 20 Amp, 125V Straight Blade (Duplex)	 -33GF 20 Amp, 125V Straight Blade Ground Fault (Duplex)	 -37 20 Amp, 250V Straight Blade (Duplex)	 -61 Dada Outlet (Cat 5 TT568B Duplex Jacks)
 E300WS Single Gang Single Face	E333WS E333SA-WS E333PB-WS	E333GF-WS E333GFSA-WS E333GFPB-WS	E337WS E337SA-WS E337PB-WS	E361WS E361SA-WS E361PB-WS
 E400WS Single Gang Double Face	E433WS E433SA-WS E433PB-WS	E433GF-WS E433GFSA-WS E433GFPB-WS	E437WS	E461WS E461SA-WS E461PB-WS
 E500WS Double Gang Single Face	E533WS E533SA-WS E533PB-WS	E533GF-WS E533GFSA-WS E533GFPB-WS	E537WS E537SA-WS E537PB-WS	E561WS E561SA-WS E561PB-WS
 E600WS Double Gang Double Face	E633WS E633SA-WS E633PB-WS	E633GF-WS E633GFSA-WS E633GFPB-WS	E637WS E637SA-WS E637PB-WS	E661WS E661SA-WS E661PB-WS
 E2300 Single Gang Flush Mount	E2333SA E2333PB	E2333GFSA E2333GFPB	E2337SA E2337PB	E2361SA E2361PB
 E2500 Double Gang Flush Mount	E2533SA E2533PB	E2533GFSA E2533GFPB	E2537GFSA E2537GFPB	E2561SA E2561PB

SERVICE FIXTURES

ACCESSORIES AND COMPONENT

Goosenecks

WaterSaver goosenecks are fabricated of 3/8" IPS heavy wall brass tubing for maximum strength and durability. Rigid goosenecks have a 3/8" IPS male inlet to thread directly into the top of the faucet body. Swing goosenecks have a Teflon packing with an adjustable packing nut. The packing nut has a 1"-22 thread to fit into faucet bodies machined with a mating female thread. Rigid/swing goosenecks have a union-style construction for field conversion from rigid to swing and vice versa.

Goosenecks are offered with integral vacuum breakers to prevent backflow. Vacuum breakers have an ultra-light float cup to prevent spillage under extreme low flow conditions.

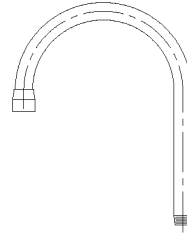

Gooseneck

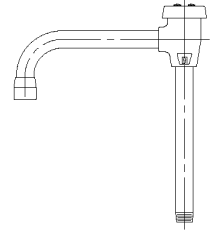

Vacuum Breaker Gooseneck

RG6	6" rigid gooseneck
RG8	8" rigid gooseneck
RG9	9" rigid gooseneck
RG10	10" rigid gooseneck
RG12	12" rigid gooseneck

SG6	6" swing gooseneck
SG8	8" swing gooseneck
SG9	9" swing gooseneck
SG10	10" swing gooseneck
SG12	12" swing gooseneck

RSG6	6" rigid/swing gooseneck
RSG8	8" rigid/swing gooseneck
RSG9	9" rigid/swing gooseneck
RSG10	10" rigid/swing gooseneck
RSG12	12" rigid/swing gooseneck

RG6VB	6" rigid vacuum breaker gooseneck
RG8VB	8" rigid vacuum breaker gooseneck
RG9VB	9" rigid vacuum breaker gooseneck
RG10VB	10" rigid vacuum breaker gooseneck
RG12VB	12" rigid vacuum breaker gooseneck

SG6VB	6" swing vacuum breaker gooseneck
SG8VB	8" swing vacuum breaker gooseneck
SG9VB	9" swing vacuum breaker gooseneck
SG10VB	10" swing vacuum breaker gooseneck
SG12VB	12" swing vacuum breaker gooseneck

RSG6VB	6" rigid/swing vacuum breaker gooseneck
RSG8VB	8" rigid/swing vacuum breaker gooseneck
RSG9VB	9" rigid/swing vacuum breaker gooseneck
RSG10VB	10" rigid/swing vacuum breaker gooseneck
RSG12VB	12" rigid/swing vacuum breaker gooseneck

Vacuum Breakers



Atmospheric Vacuum Breaker

3/8" IPS female inlet

L100.....

1/2" IPS female inlet

L101.....

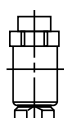

Dual Check Backflow Preventer

For continuous pressure applications.
3/8" IPS female inlet and outlet

L108.....



Dual Check Vacuum Breaker

3/8" IPS male inlet

3/8" IPS female outlet

L108.....

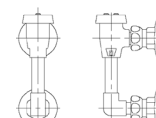

Atmospheric Vacuum Breaker

For panel or wall mounting
1/2" IPS female inlet and outlet

L102.....

With mounting shanks, locknuts and washers

L102SWSA.....

3/8" IPS female inlet and outlet

L112.....

With mounting shanks, locknuts and washers

L112SWSA.....

SERVICE FIXTURES

ACCESSORIES AND COMPONENT

Outlet Fittings

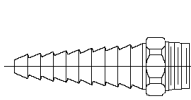

Straight Ten Serration Hose End

3/8"IPS male inlet

BO140S.....

3/8"NPT male inlet

BO140T.....

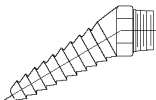

Angle Ten Serration Hose End

3/8"IPS male inlet

BO140S.....

3/8"NPT male inlet

BO140T.....

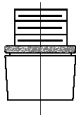

Aerator

3/8"IPS male inlet

BO055.....

Internal Flow Control
Specify flow rate in GPM when ordering

BO055FC.....

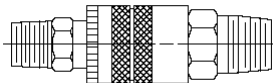

Quick Connect Fitting

3/8"IPS male inlet, 1/4" IPS male outlet

BO188.....

1/4" IPS male inlet

BO189.....

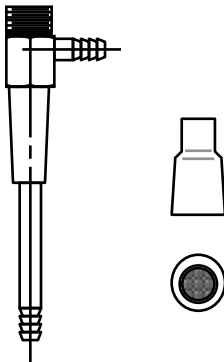

Aspirator

3/8"IPS male inlet

BO127S.....

Splash eliminator for use with BO127S aspirator

BO125.....

Mounting Fittings

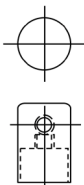

Deck Mounted Turret Base

3/8"IPS female inlet
3/8" IPS female outlet

BI131.....

Outlets(2) 90°

BI132A.....

Outlets(2) 180°

BI132S.....

Outlets(3)

BI133.....

Outlets(4)

BI134.....

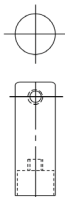

Deck Mounted Tall Turret Base

3/8"IPS female inlet
3/8" IPS female outlet

BI176.....

Outlets(2) 90°

BI176-2A.....

Outlets(2) 180°

BI176-2S.....

Outlets(3)

BI176-3.....

Outlets(4)

BI176-4.....

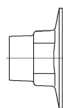

Panel Mounted Flange

3/8"IPS female inlet and outlet

B158.....



Panel Mounted WYE Fitting

3/8"IPS female inlet

3/8" IPS female outlets(2) at 90°

B141.....

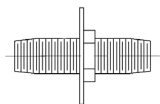

Mounting Shank with Locknut and Washer

3/8"IPS x 2-1/2"L

BI136-02-08R.....

3/8"IPS x 3-1/2"L

BI136-03-08R.....

3/8"IPS x 4"L

BI136-04R.....

3/8"IPS x 4"L

BI136-6R.....

SERVICE FIXTURES

FAUCETS

Spout

- **Body:** Forged brass with polished chrome plated finish.
- **Gooseneck:** 6" rigid gooseneck with 3/8" IPS female outlet and removable ten serration hose end.
- **Vacuum Breaker:** Integral vacuum braker to prevent backflow. Vacuum Breaker has replaceable seat and ultra-light float cup to reist spilling at low flow.
- **Inlet:** 3/8" IPS female inlet. Furnished completely assembled with mounting shank, locknut and washer.

Mixing Faucet (Inlets on 3" Vertical Centers)

- **Body:** Cast brass with polished chrome plated finish.
- **Valve Unit:** WaterSaver self-contained renewable unit with replaceable stainless steel seats.
- **Handle:** Forged brass four-arm handles with color-coded index discs.
- **Gooseneck:** 6" rigid gooseneck.
- **Inlet:** 3/8" IPS female union inlets. Furnished complete with mounting shanks, locknuts and washers. If mounting shanks are to be assembled, use suffix "WSA" in place of "WS".
- **Outlet:** 3/8" IPS female outlet with removable ten serration hose end.

Note: For Aerator in place of Hose End, add suffix "-55" to end of model number.

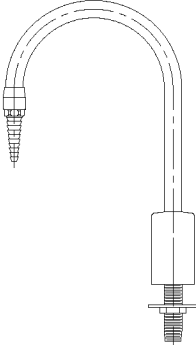
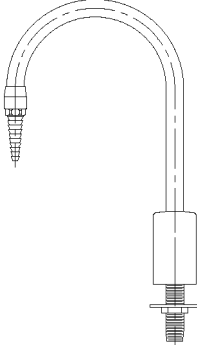
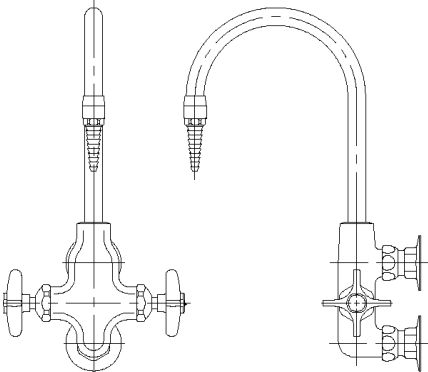
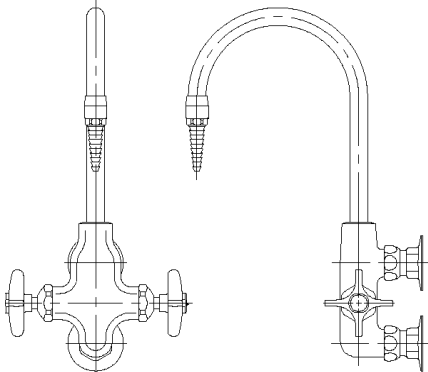
<p>L084-55WSA.....DECK MOUNTEDAERATOR</p> 	<p>L084VB-55WSA.....DECK MOUNTEDAERATOR OUTLETVACUUM BREAKER</p> 
<p>L214WSA.....PANEL MOUNTED</p> 	<p>L214VB-WSA.....PANEL MOUNTEDVACUUM BREAKER</p> 

SERVICE FIXTURES

FAUCETS

**Faucet on 8" centers
for cold or hot water**

- **Body:** Forged brass with polished chrome plated finish.
- **Valve Unit:** WaterSaver self-contained renewable unit with replaceable stainless steel seats.
- **Handle:** Forged brass four-arm handle with color-coded index disc.
- **Gooseneck:** : 6" rigid gooseneck.
- **Inlet:** (2) 3/8" OD flexible copper tubing, (2) 1-3/8"-18 and center 3/8" IPS mounting shanks with locknuts and washers, 12" flexible hose.
- **Outlet:** 3/8" IPS female outlet with removable ten serration hose end.

Note: For Aerator in place of Hose End, add suffix "-55" to end of model number.

**Faucet on 8" centers
for cold or hot water**

- **Body:** Forged brass with polished chrome plated finish.
- **Valve Unit:** WaterSaver self-contained renewable unit with replaceable stainless steel seats.
- **Handle:** 4" Forged brass four-arm handle with color-coded index disc.
- **Gooseneck:** : 6" rigid gooseneck.
- **Inlet:** (2) 3/8" OD flexible copper tubing, (2) 1-3/8"-18 and center 3/8" IPS mounting shanks with locknuts and washers, 12" flexible hose.
- **Outlet:** 3/8" IPS female outlet with removable ten serration hose end.

Note: L2221 and L2221VB are ADA Compliant

Note: For Aerator in place of Hose End, add suffix "-55" to end of model number.

L2211.....DECK MOUNTED

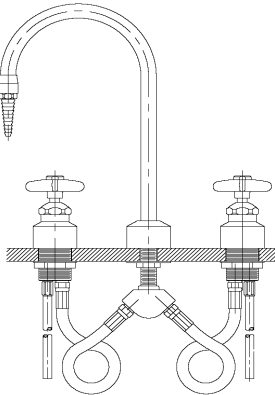

L2211TWI-3001.....Deck Mounted
.....Foot-Operated+Self-Closing Mixing Valve
L2212.....6" swing gooseneck
L2214.....6" rigid/swing gooseneck
L2214TWI-3001.....Deck Mounted
.....Foot-Operated+Self-Closing Mixing Valve

L2211VB.....DECK MOUNTED
.....VACUUM BREAKER

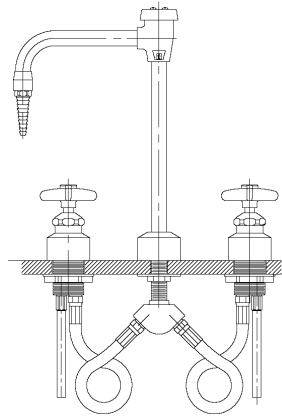

L2211TWI-VB-3001.....Deck Mounted
.....Foot-Operated+Self-Closing Mixing Valve
L2212VB.....6" swing gooseneck
L2214VB.....6" swing gooseneck
L2214-8VB.....8" rigid/swing gooseneck
L2214TWI-VB-3001.....Floor Mounted
.....Foot-Operated+Self-Closing Mixing Valve

L2211.....DECK MOUNTED
.....WRIST-BLADE HANDLES
.....AERATOR OUTLET

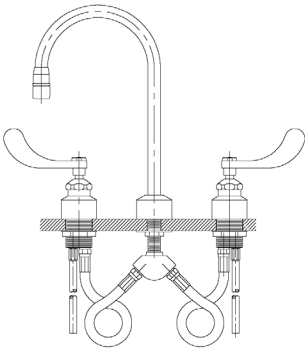

L2222.....6" swing gooseneck
L2224.....6" rigid/swing gooseneck
L2214TWI-3001.....Floor Mounted
.....Foot-Operated+Self-Closing Mixing Valve

L2221VB.....DECK MOUNTED
.....WRIST-BLADE HANDLES
.....AERATOR OUTLET
.....VACUUM BREAKER

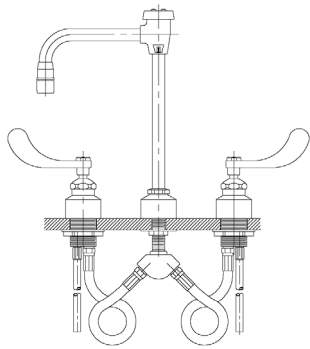

L2222VB.....6" swing gooseneck
L2224VB.....6" rigid/swing gooseneck
L2224TWI-VB-3001.....Floor Mounted
.....Foot-Operated+Self-Closing Mixing Valve

SERVICE FIXTURES

FAUCETS

Single Faucet for cold or hot water

- **Body:** Forged brass with polished chrome plated finish.
- **Valve Unit:** WaterSaver self-contained renewable unit with replaceable stainless steel seats.
- **Handle:** Forged brass four-arm handle with color-coded index disc.
- **Gooseneck:** : 6" rigid gooseneck.
- **Vacuum Breaker:** Integral vacuum breaker to prevent backflow. Vacuum Breaker has replaceable seat and ultra-light float cup to resist spilling at low flow.
- **Inlet:** 1/2" IPS female inlet with mounting shank, locknut and washer.
- **Outlet:** 3/8" IPS female outlet with removable ten serration hose end.

Note: For Aerator in place of Hose End, add suffix "-55" to end of model number.

L2714VB-WSA.....PANEL MOUNTED
.....VACUUM BREAKER

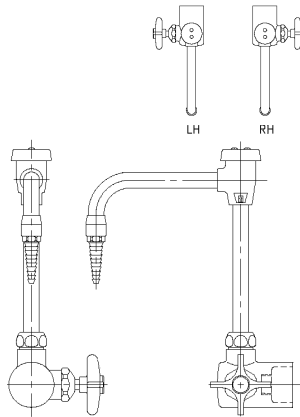

L2714WSA.....Right Handed Configuration
L2714-VB-WSA.....6" Rigid/Swing Gooseneck
.....Left Handed Configuration
L2714L-VB-WSA.....6" rigid/swing gooseneck
.....Vacuum Breaker + Left Handed Configuration

Tin-Lined Pure Water Faucet

All components in contact with water have pure tin coating. Body and gooseneck are dipped in liquid tin to coat all interior surfaces.

- **Body:** Forged brass with polished chrome plated finish.
- **Valve Unit:** WaterSaver self-contained renewable unit with replaceable stainless steel seat.
- **Handle:** White nylon four-arm handle with color-coded index disc.
- **Gooseneck:** : 6" rigid/swing gooseneck.
- **Inlet:** 1/2" IPS female inlet. Furnished complete with mounting shanks, locknuts and washers. If mounting shank is to be assembled, use suffix "WSA" in place of "WS".
- **Outlet:** 3/8" IPS female outlet with removable ten serration hose end.

Note: If Vacuum Breaker is required, add suffix "VB"

Note: For Aerator in place of Hose End, add suffix "-55" to end of model number.

L2784WSA.....PANEL MOUNTED
.....SELF-CLOSING CONTROL

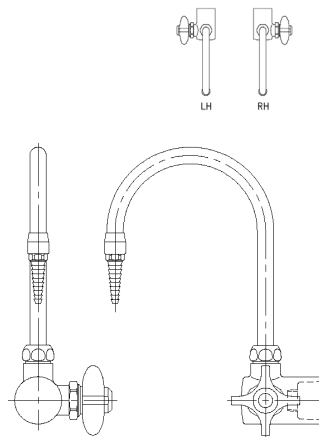

L2784L-WSA.....Left Handed Configuration
L2794-WSA.....Manual Control
L2794L-WSA.....Manual Control
.....Left Handed Configuration

Options for Pure Water Faucets

- **Valve Units:** Internal adjustable volume control on valve unit (add suffix "AC").
- **Handle:** 4" Wrist blade handle in place of four-arm handle (add suffix "BH").
Lever handle in place of four-arm handle ("add suffix "LE").
- **Gooseneck:** 8" spread gooseneck in place of 6" (add the number "8").

SERVICE FIXTURES

VALVES

Laboratory Water Valve with inlet and outlet at 180° (L2800-131WS)

- **Mounting:** Deck mounted turret base with single valve.
- **Valve Body:** Forged brass with polished chrome plated finish.
- **Valve Unit:** WaterSaver self-contained renewable unit with replaceable stainless steel seat.
- **Handle:** Forged brass four-arm handle with color-coded index disc.
- **Inlet:** 3/8" IPS male inlet.
- **Outlet:** 3/8" IPS female outlet with removable ten serration hose end.

Additional Models:

- L2800-131WSA** Deck mounted turret water valve fixture.
- L2800-132AWSA** Deck mounted 90° 2 way-turret water valve fixture.
- L2800-132SWSA** Deck mounted 180° 2 way-turret water valve fixture.
- L2800-133WSA** Deck mounted 3 way-turret water valve fixture.
- L2800-134WSA** Deck mounted 4 way-turret water valve fixture.
- L2800-141FT** Deck mounted 90° 2 way-flanged water valve fixture.
- L2800-141WSA** Panel mounted 90° 2 way-flanged water valve fixture.
- L2800-131WSA** Deck mounted single turret needle valve fixture.
- L2800-132SWSA** Deck mounted 180° 2 way-turret needle valve fixture.
- L2800-133WSA** Deck mounted 3 way-turret needle valve fixture.
- L2800-134WSA** Deck mounted 4 way-turret needle valve fixture.
- L2800-141FT** Wall mounted 90° 2 way-flanged needle valve fixture.
- L2800-141WSA** Panel mounted 90° 2 way-flanged needle valve fixture.

Note: Valve assemblies are furnished with mounting shank, locknut and washer (designated by "WS"). If mounting shank is to be assembled, use suffix "WSA".

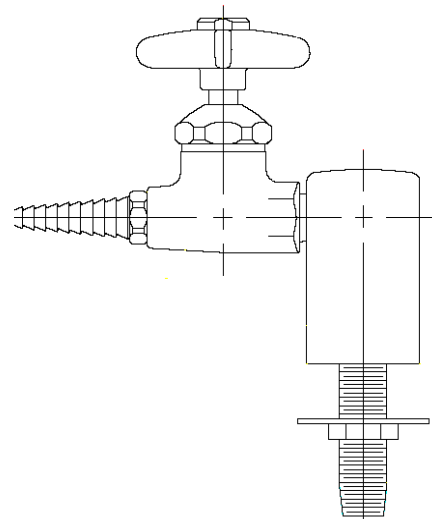

Low Pressure Laboratory Steam (L2890-131WS)

Maximum working pressure is 20 PSI.

- **Mounting:** Deck mounted turret base with single valve.
- **Valve Body:** Forged brass with polished chrome plated finish.
- **Valve Unit:** Globe valve design with glass-filled TFE valve disc and stem packing. Replaceable stainless steel seat.
- **Handle:** Heat resistant black nylon four-arm handle with color-coded index disc.
- **Inlet:** 3/8" IPS male inlet.
- **Outlet:** 3/8" IPS female outlet with removable ten serration hose end.

Additional Models:

- L2890-131WSA** Deck mounted single turret ball valve fixture.
- L2890-132AWSA** Deck mounted 90° 2-way turret ball valve fixture.
- L2890-132SWSA** Deck mounted 180° 2-way turret ball valve fixture.
- L2890-133WSA** Deck mounted 3 way-turret ball valve fixture.
- L2890-134WSA** Deck mounted 4 way-turret ball valve fixture.
- L2890-141FT** Wall mounted 90° 2 way-flanged ball valve fixture.
- L2890-141WSA** Panel mounted 90° 2 way-flanged ball valve fixture.

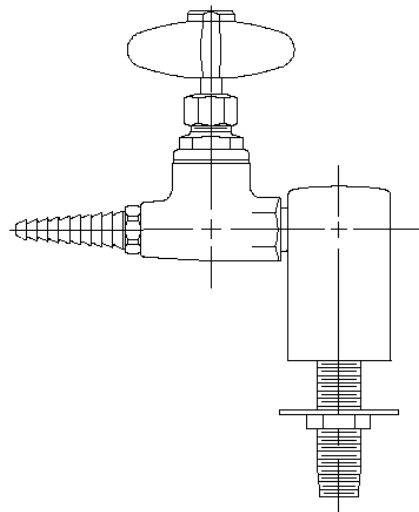

SERVICE FIXTURES

VALVES

Floor mounted foot-operated self-closing mixing valve(L3000)

- **Body:** Forged brass with polished chrome plated finish.
- **Valve Unit:** Self-closing renewable units with stainless steel valve stem.
- **Pedals:** Cast aluminum pedals mounted on hinged bracket.
- **Inlet(L3001):** (2) 1/2" IPS female inlets
- **Inlet(L3050):** 1/2" IPS female inlet (back)
- **Outlet(L3001):** 1/2" IPS female outlet
- **Outlet(L3050):** 1/2" IPS female outlet (top)

Note: A foot-operated valve can be combined with a deck mount mixing faucet to create a faucet with both hand and foot controls. See page ____.

L3001.....MIXING VALVE

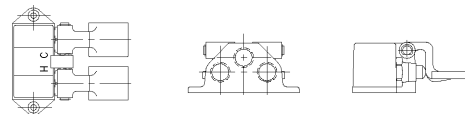

L3050.....SINGLE VALVE

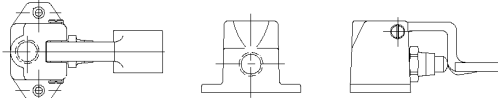

Ball Valve Assembly (L4000)

On/off control of all laboratory gases. For use at pressures up to 75 PSI. When ordered, valve may be specially cleaned, lubricated and packaged for pure gas service. Valve is certified for gas service by the American Gas Association (AGA) and the Canadian Gas Association (CGA). Valve is recommended for ADA-Compliant applications.

- **Mounting**
- **Valve Body:** Forged brass with polished chrome plated finish.
- **Valve Unit:** Quarter-turn open/close with chrome plated brass ball and molded TFE seals.
- **Handle:** Chrome plated forged brass lever handle with color-coded index disc.
- **Inlet:** 3/8" IPS male inlet.
- **Outlet:** Integral (non-removable) seven serration hose end.

Note: L4100, L4100-131WS, and L4100-158WS are ADA Compliant

Additional Models:

L4100 Integral hose end(s)

L4200 Removable hose end(s)

L4_00-131WSA Deck mounted single turret ball valve fixture with integral hose end.

L4_00-132AWSA Deck mounted 90° 2-way turret ball valve fixture with integral hose ends

L4_00-132SWSA Deck mounted 180° 2-way turret ball valve fixture with integral hose ends.

L4_00-133WSA Deck mounted 3 way-turret ball valve fixture with integral hose ends.

L4_00-134WSA Deck mounted 4 way-turret ball valve fixture with integral hose ends

L4_00-141FT Wall mounted 90° 2 way-flanged ball valve fixture with integral hose ends.

L4_00-141WSA Panel mounted 90° 2 way-flanged ball valve fixture with integral hose ends.

L4_00-158FT Wall mounted single flanged ball valve fixture with integral hose ends.

L4_00-158WSA Panel mounted single flanged ball valve fixture with integral hose ends.

L4100.....

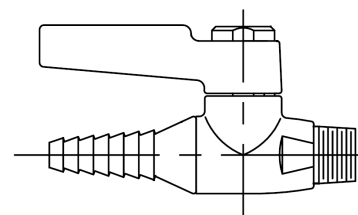

L4100-131WS.....

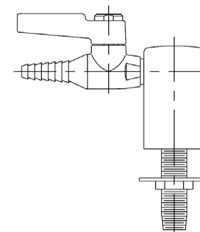

L4100-158WS.....

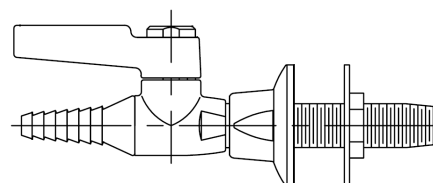

SERVICE FIXTURES

VALVES AND FAUCETS

Flange with Single Valve

Furnished with 3/8" IPS mounting shank, locknut, and washer.

- **Valve Body:** Forged brass with polished chrome plated finish.
- **Valve Unit:** Globe valve design with glass-filled TFE valve disc and stem packing. Replaceable stainless steel seat.
- **Handle:** Forged brass four-arm handle with color-coded index disc.
- **Outlet:** 3/8" IPS female outlet with removable ten serration hose end.

Note: For Aerator in place of Hose End, add suffix "-55" to end of model number.

Faucet for hot and cold water with horizontal inlets on 8" centers

- **Body:** Cast brass with polished chrome plated finish.
- **Valve Unit:** WaterSaver self-contained renewable unit with replaceable stainless steel seats.
- **Handle:** Forged brass four-arm handle with color-coded index disc.
- **Gooseneck:** : 6" rigid gooseneck.
- **Inlet:** 3/8" IPS female union inlets. Furnished complete with mounting shanks, locknuts and washers. If mounting shanks are to be assembled, use suffix "WSA" in place of "WS".
- **Outlet:** 3/8" IPS female outlet with removable ten serration hose end.

Note: For Aerator in place of Hose End, add suffix "-55" to end of model number.

Single Flanged Water Valve

- L4800F-225WSA**.....PANEL MOUNTED
- L4800FT-325**.....WALL MOUNTED

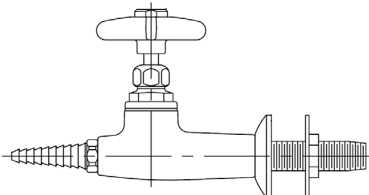

Single Flanged Needle Valve Fixture

- L4880F-225**.....Needle Valve Fixture
- L4880FT-325**.....Needle Valve Fixture
.....(For Stub-Out Application)

Single Flanged Steam Valve Fixture

- L4890F-225**.....Steam Valve Fixture
- L4890FT-325**.....Steam Valve Fixture
.....(For Stub-Out Application)

- L514WSA**.....PANEL MOUNTED
- L514VB-WSA**.....VACUUM BREAKER

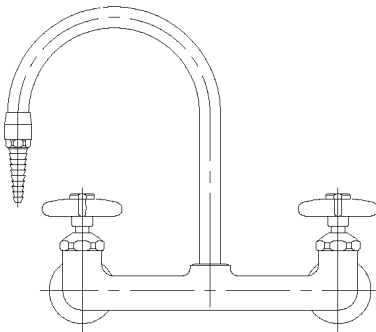

SERVICE FIXTURES

MIXING FAUCETS

Mixing Faucet

- **Body:** Forged brass with polished chrome plated finish.
- **Valve Unit:** WaterSaver self-contained renewable unit with replaceable stainless steel seats.
- **Handle:** Forged brass four-arm handle with color-coded index disc.
- **Gooseneck:** 6" rigid gooseneck.
- **Inlet:** (2) 3/8" OD flexible copper tubing, 1-3/16"-18 mounting shank with locknut and washer.
- **Outlet:** 3/8" IPS female outlet with removable ten serration hose end.

L2714VB-WSA.....PANEL MOUNTED

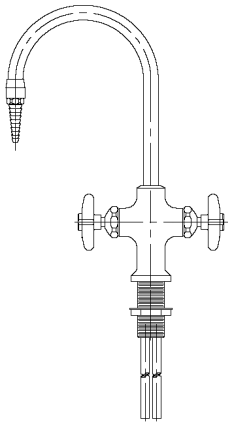

L412.....Swing Gooseneck
L414.....Rigid/Swing Gooseneck

L411VB.....DECK MOUNTED
.....VACUUM BREAKER

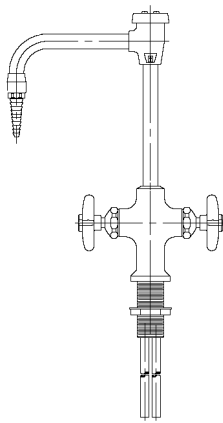

L412VB.....Swing Gooseneck
L414VB.....Rigid/Swing Gooseneck

Faucet for hot and cold water

- **Body:** Forged brass with polished chrome plated finish.
- **Valve Unit:** WaterSaver self-contained renewable unit with replaceable stainless steel seats.
- **Handle:** Forged brass four-arm handles with color-coded index discs.
- **Spout:** 9" swing spout
- **Inlet:** (2) 3/8" OD flexible copper tubing, 1-3/16"-18 mounting shank with locknut and washer.
- **Outlet:** 3/8" IPS female outlet with removable aerator.

L410.....DECK MOUNTED
.....SWING SPOUT

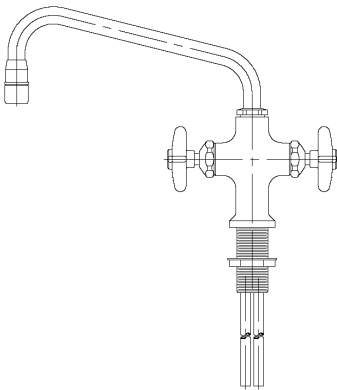

L410VB.....Vacuum Breaker

SERVICE FIXTURES

FAUCETS

Single Faucet for cold or hot water

- **Body:** Forged brass with polished chrome plated finish.
- **Valve Unit:** WaterSaver self-contained renewable unit with replaceable stainless steel seats.
- **Handle:** Forged brass four-arm handle with color-coded index disc.
- **Gooseneck:** 6" rigid gooseneck. Gooseneck is set in right hand configuration unless left hand or 180 degrees is specified.
- **Inlet:** 3/8" IPS male shank with locknut and washer.
- **Outlet:** 3/8" IPS female outlet with removable ten serration hose end.

Note: For Aerator in place of Hose End, add suffix "-55" to end of model number.

L611.....DECK MOUNTED

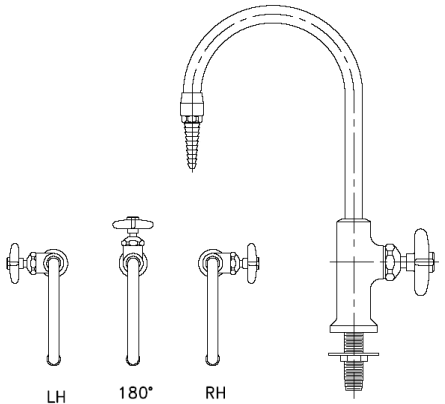

- L611-180.....180° Handle
- L611LH.....Left Handle
- L611RH.....Right Handle
- L614-180.....180° Handle
-Rigid/Swing Gooseneck
- L614LH.....Left Handle
-Rigid/Swing Gooseneck
- L614RH.....Right Handle
-Rigid/Swing Gooseneck

L611VB.....DECK MOUNTEDVACUUM BREAKER

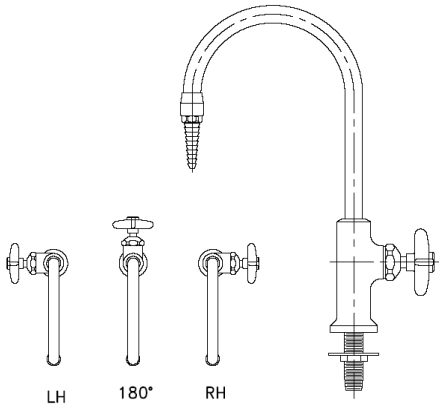

- L611VB-180.....180° Handle
- L611VBLH.....Left Handle
- L611VBLH.....Right Handle
- L614VB-180.....180° Handle
-Rigid/Swing Gooseneck
- L614VBLH.....Left Handle
-Rigid/Swing Gooseneck
- L614VBRH.....Right Handle
-Rigid/Swing Gooseneck

Tin-Lined Pure Water Faucet

All components in contact with water have pure tin coating. Body and gooseneck are dipped in liquid tin to coat all interior surfaces.

- **Body:** Forged brass with polished chrome plated finish.
- **Valve Unit:** WaterSaver self-contained renewable unit with replaceable stainless steel seats.
- **Handle:** White nylon four-arm handle with color-coded index disc.
- **Gooseneck:** 6" rigid gooseneck.
- **Inlet:** 3/8" IPS mounting shank with locknut and washer, 1/4" NPT tailpiece.
- **Outlet:** 3/8" IPS female outlet with removable ten serration hose end.

Note: For Aerator in place of Hose End, add suffix "-55" to end of model number.

L684.....DECK MOUNTEDSELF-CLOSING CONTROL

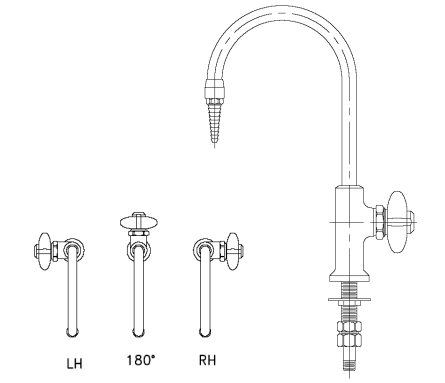

- L684-180.....180° Handle
- L684LH.....Left Handle
- L684RH.....Right Handle

L684VB.....DECK MOUNTEDSELF-CLOSING CONTROLVACUUM BREAKER

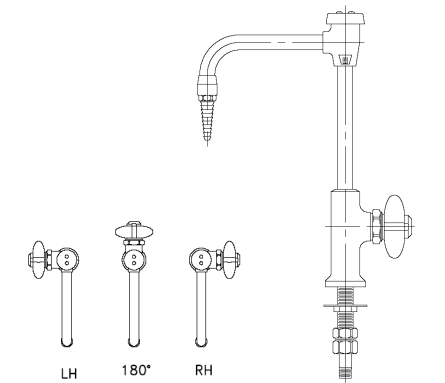

- L684VB-180.....180° Handle
- L684VBLH.....Left Handle
- L684VBRH.....Right Handle

SERVICE FIXTURES

FAUCETS

Tin-Lined Pure Water Faucet

All components in contact with water have pure tin coating. Body and gooseneck are dipped in liquid tin to coat all interior surfaces.

- **Body:** Forged brass with polished chrome plated finish.
- **Valve Unit:** WaterSaver self-contained renewable unit with replaceable stainless steel seat. Valve has manual on/off (compression) control.
- **Handle:** Forged brass four-arm handle with color-coded index disc.
- **Gooseneck:** 6" rigid gooseneck.
- **Inlet:** 3/8" IPS mounting shank with locknut and washer, 1/4" NPT tailpiece.
- **Outlet:** 3/8" IPS female outlet with removable ten serration hose end.

Note: For Aerator in place of Hose End, add suffix "-55" to end of model number.

Polypropylene Lined Pure Water Faucet

Faucet has exterior brass casing and interior lining of inert polypropylene. Pure water comes in contact only with inert plastic.

- **Body:** Forged brass with polished chrome plated finish.
- **Valve Unit:** Diaphragm-type valve. Brass valve stem and bonnet with elastomer diaphragm. Valve has manual on/off control.
- **Handle:** White nylon four-arm handle with color-coded index disc.
- **Gooseneck:** 6" Rigid brass riser.
- **Inlet:** 3/8" IPS male shank with 3/8" OD tube connection. Furnished with 3/8" OD compression adaptor for inlet.
- **Outlet:** Seven serration plastic hose end.

Note: For Aerator in place of Hose End, add suffix "-55" to end of model number.

L694.....DECK MOUNTED
.....MANUAL CONTROL

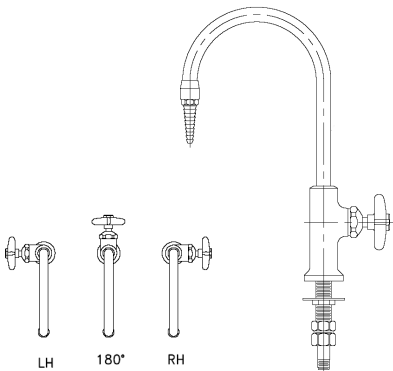

L694-180.....180° Handle
L694LH.....Left Handle
L694RH.....Right Handle

L684VB.....DECK MOUNTED
.....MANUAL CONTROL
.....VACUUM BREAKER

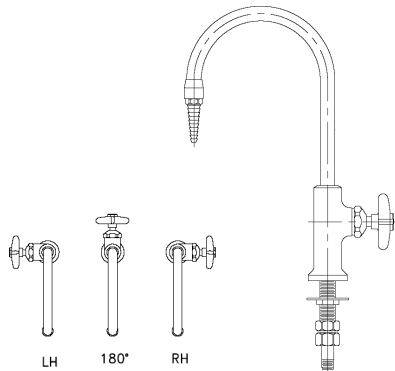

L694VB-180.....180° Handle
L694VBLH.....Left Handle
L694VBRH.....Right Handle

L7833.....DECK MOUNTED

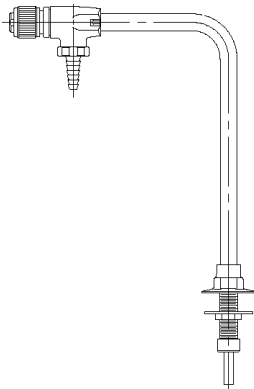

L7834.....PANEL MOUNTED

SERVICE FIXTURES

PRE-RINSE UNITS

Hot and Cold Water Pre-Rinse Unit

- **Body:** Cast brass with polished chrome plated finish.
- **Valve Unit:** WaterSaver self-contained renewable units with replaceable stainless steel seats and integral check valves. Check valves prevent cross-mixing of hot and cold water.
- **Handle:** Forged brass four-arm handles with color-coded index discs.
- **Pre-Rinse Assembly:** Self-closing squeeze valve with rubber-bound spray head, insulated handle and locking ring. Valve is mounted on spring loaded 39" stainless steel hose.
- **Inlet:** 1 3/16" male shank with (2) 1/2" OD slipjoint connections. Furnished complete with locknut, washer and inlet fittings.

PR1711.....DECK MOUNTED
.....SELF-CLOSING SQUEEZE VALVE

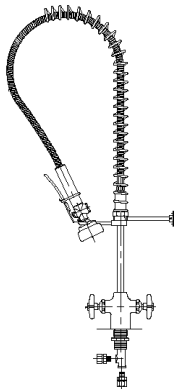

PR411-110.....Vacuum Breaker

PR1711WS.....PANEL MOUNTED
.....SELF-CLOSING SQUEEZE VALVE

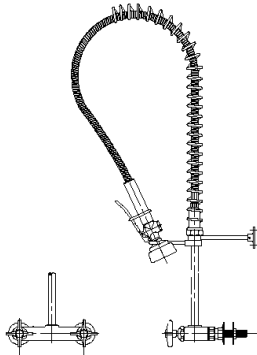

PR411-110WS.....Vacuum Breaker

Options for Service Fixtures

- For an 8" Gooseneck in place of 6" (add suffix "-8").
- Add for (1) each 4" Wrist Blade Handle in place of four-arm handle. (add suffix "-8").

PVC Hose with Quick Connect assembled to one end.
L4200-158FT Fixture
Quick Connect Fixture for OHSP

G-AUT.....

Stainless Steel Hose with Quick Connect assembled to one end.
L4200-158FT Fixture
Quick Connect Fixture for OHSP
For natural gass

G-SS-AUT.....

SAFETY EQUIPMENT

EYEWASHES

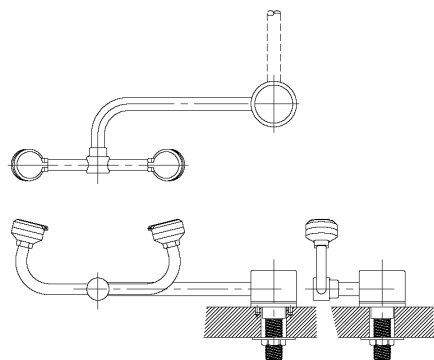

Deck Mounted Eyewash (EW805)

Low profile "Auto Flow" 90° Swivel Style with (2) Gentle.

- **Spray Head Assembly:** Two GS-Plus spray heads. Each head has a "flip top" dust cover, internal flow control and filter to remove impurities from the water flow.
- **Valve:** 1/2" IPS brass stay-open ball valve mechanically linked to outlet head assembly. Swinging head assembly 90 degrees from storage to operational position activates water flow. Unit remains in operation until head assembly is returned to storage position.
- **Mounting:** Unit mounts on countertop on right hand side of sink. Furnished with 1/2" IPS mounting shank with locknut and washer.
- **Supply:** 1/2" IPS female inlet.

Additional Model: EW805LH (same as above except unit mounts on left side of sink)

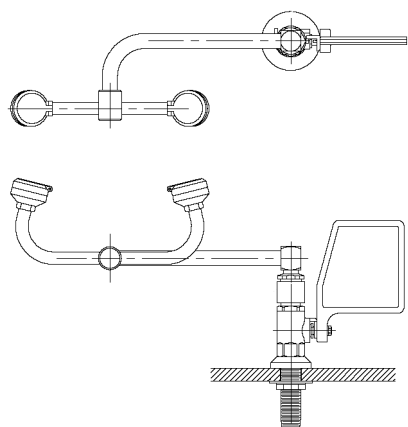

Deck Mounted Eyewash (EW806)

Stay-Open Ball Valve 90° Swivel Style with (2) Gentle.

- **Spray Head Assembly:** Two GS-Plus spray heads. Each head has a "flip top" dust cover, internal flow control and filter to remove impurities from the water flow.
- **Valve:** 1/2" IPS brass stay-open ball valve with flag handle.
- **Mounting:** Unit mounts on countertop on right hand side of sink. Outlet heads swivel 90 degrees from storage to operational position. Furnished with 1/2" IPS mounting shank with locknut and washer.
- **Supply:** 1/2" IPS female inlet.

Additional Model: EW806LH (same as above except unit mounts on left side of sink)

Deck Mounted Eyewash (EW822)

Deck Mounted Stay-Open Ball Valve, Stainless Steel Bowl with (2) Gentle Spray Outlet Heads.

Wall Mounted Eyewash (EW848)

Wall Mounted Stay-Open Ball Valve, "Auto Flow" 90° Swing-Down Style with (2) Gentle Spray Outlet Heads, and Mounts behind sink (Specify Configuration- See Catalog)

Additional Model: EW848LH (same as above except unit mounts on left side of sink)

Note: All units supplied with ANSI compliant identification sign.

SAFETY EQUIPMENT

EYEWASHES

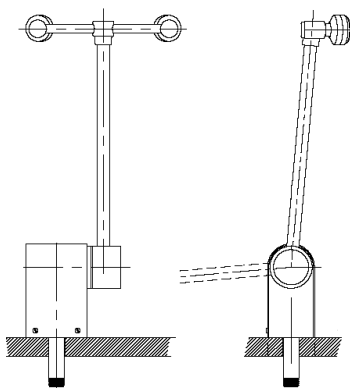

Deck Mounted Eyewash (EW849)

“Auto-Flow” 90° Swing-Down Style, Stay-Open Ball Valve with (2) Gentle Spray Outlet Heads, and mounts behind sink (Specify Configuration- See Catalog)

- **Spray Head Assembly:** Two GS-Plus spray heads. Each head has a “flip top” dust cover, internal flow control and filter to remove impurities from the water flow.
- **Valve:** 1/2” IPS brass stay-open ball valve mechanically linked to outlet head assembly. Swinging head assembly 90 degrees from storage to operational position activates water flow. Unit remains in operation until head assembly is returned to storage position.
- **Mounting:** Unit mounts on countertop on right hand side of sink. Furnished with 1/2” IPS mounting shank with locknut and washer.
- **Supply:** 1/2” IPS male inlet.

Additional Configurations:

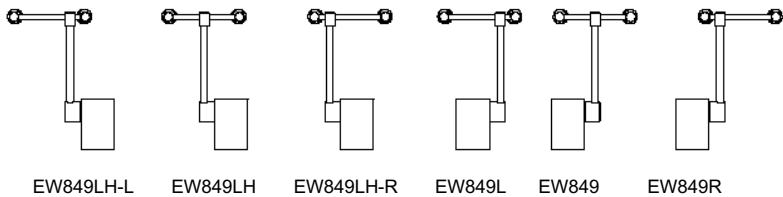

Deck Mounted Eyewash (EWBF849)

ADA Compliant, “Auto-Flow” 90° Swing-Down Style, Stay-Open Ball Valve with (2) Gentle Spray Outlet Heads, and mounts behind sink (Specify Configuration- See Catalog)

- **Spray Head Assembly:** Two GS-Plus spray heads. Each head has a “flip top” dust cover, internal flow control and filter to remove impurities from the water flow.
- **Valve:** 1/2” IPS brass stay-open ball valve mechanically linked to outlet head assembly. Swinging head assembly 90 degrees from storage to operational position activates water flow. Unit remains in operation until head assembly is returned to storage position.
- **Mounting:** Unit mounts on countertop on right hand side of sink. Furnished with 1/2” IPS mounting shank with locknut and washer.
- **Supply:** 1/2” IPS male inlet.

Additional Model: EWBF849LH (same as above except unit mounts on left side of sink)

Thermostatic Mixing Valve for Eyewashes
6 Gallon Capacity
AP3600.....

Thermostatic Mixing Valve for Emergency
Showers & Safety Stations
44 Gallon Capacity
AP3800.....

Thermostatic Mixing Valve for Barrier-Free Eyewashes
G3600.....

Note: All units supplied with ANSI compliant identification sign.

SAFETY EQUIPMENT

DRENCH HOSE UNITS

Hand-Held Drench Hose

- **Spray Head Assembly:** Single FS-Plus spray head. Spray head has "flip top" dust cover, internal flow control and filter to remove impurities from the water flow.
- **Valve:** Single FS-Plus spray head. Spray head has "flip top" dust cover, internal flow control and filter to remove impurities from the water flow.
- **Hose:** 8' reinforced PVC hose. 300 PSI maximum rated working pressure.
- **Mounting:** Nylon deck flange for countertop mounting
- **Supply:** 3/8" IPS male swivel-type inlet.

EW1020.....DECK MOUNTED

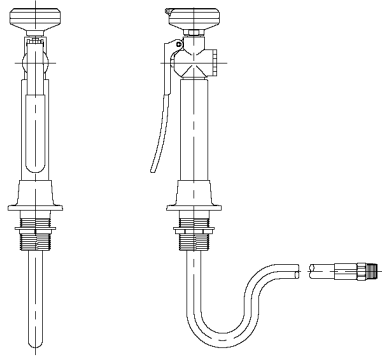

EW1025.....Wall Mounted with bracket

Dual Head Drench Hose

- **Spray Head Assembly:** Two GS-Plus spray heads mounted side-by-side. Each spray head has "flip top" dust cover, internal flow control and filter to remove impurities from the water flow.
- **Valve:** Forged brass squeeze valve activated by stainless steel lever handle. Valve has locking clip which engages when handle is depressed, providing "hands free" operation. Valve stays open until locking clip is released.
- **Hose:** 8' reinforced PVC hose. 300 PSI maximum rated working pressure.
- **Mounting:** Nylon deck flange for countertop mounting. Flange has handle locator guides to assure that spray heads and handle face forward at all times.
- **Supply:** 3/8" IPS male swivel-type inlet.

EW1022.....DECK MOUNTED

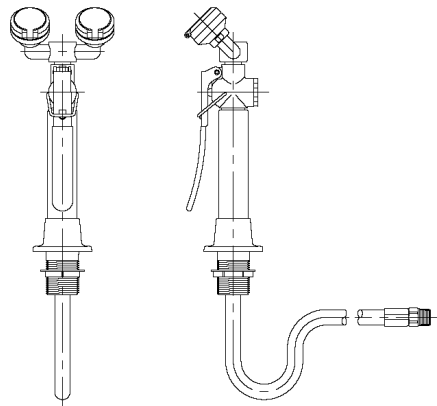

ESBF635.....ADA Compliant

ES692.....Stainless Steel Compliant

Options for Drench Hose Units

- Backslow preventer for installation on inlet of hose (add suffix "BP").
- 8ft. flexible stainless steel hose in place of PVC (add suffix "FSH").
- In-line vacuum breaker for installation between valve and spray head. (add suffix "VB").
- Stainless steel dust cover for each outlet (add suffix "DC").
- Undercounter hose guide bracket to prevent hose from tangling or binding (add suffix "HG").

Note: All units supplied with ANSI compliant identification sign.

SAFETY EQUIPMENT

EMERGENCY SHOWERS

Emergency Shower

- **Shower Head:** 10" diameter stainless steel with face plate
- **Valve:** 1" IPS chrome plated brass stay-open ball valve. Furnished with stainless steel actuating arm and 29" stainless steel pull rod.
- **Supply:** 1" IPS female inlet.

ES629.....RECESSED

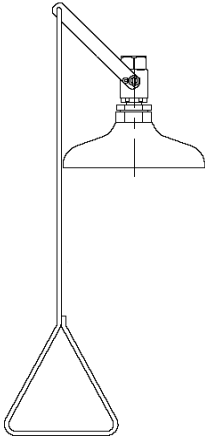

Options for Emergency Showers

- Safety green ABS plastic shower head (add suffix "GRN").
- Safety yellow ABS plastic shower head (add suffix "YEL").
- Polished chrome plated cast brass shower head (add suffix "PCH").
- Stainless steel shower head (add suffix "SS").

Emergency Shower

- **Shower Head:** 10" diameter safety orange ABS plastic.
- **Valve:** 1" IPS chrome plated brass stay-open ball valve. Furnished with stainless steel actuating arm and 29" stainless steel pull rod.
- **Supply:** 1" IPS female inlet.

ES635.....VERTICALLY MOUNTED

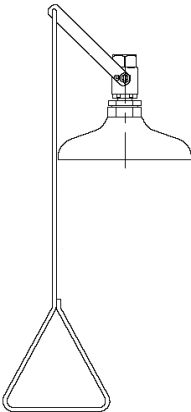

ESBF635.....ADA Compliant
ES692.....Stainless Steel Compliant

ES643.....HORIZONTALLY MOUNTEDWALL MOUNTED

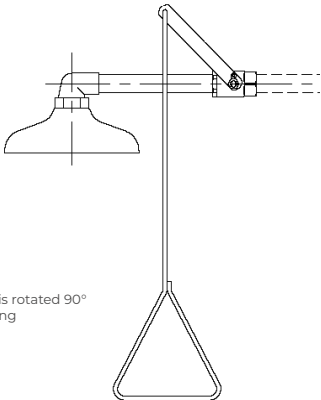

ESBF643.....ADA Compliant
ES691.....Stainless Steel Compliant

Note: All units supplied with ANSI compliant identification sign.

SAFETY EQUIPMENT

SAFETY STATION

Safety Station

- **Shower Head:** 10" diameter safety orange ABS plastic.
- **Shower Valve:** 1" IPS brass stay-open ball valve with stainless steel actuating arm and stainless steel pull rod.
- **Spread Head Assembly:** Two GS-Plus spray heads. Each spray head has "flip top" dust cover, internal flow control and filter to remove impurities from water.
- **Bowl:** 11-12" stainless steel
- **Eyewash Valve:** 1/2" IPS brass stay-open ball valve with flag handle
- **Pipe and Fittings:** Schedule 40 galvanized steel with orange polyethylene covers for high visibility and corrosion resistance.
- **Supply:** 1-1/4" IPS female top inlet
- **Waste:** 1-1/4" IPS female outlet

SS902.....FLOOR MOUNTED

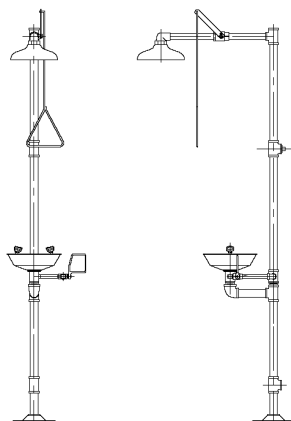

SS902P.....ABS Plastic Bowl
SS991.....Stainless Steel Construction

Safety Station

- **Installation:** Unit complies with ADA requirements for accessibility by handicapped persons.
- **Shower Head:** 10" diameter safety orange ABS plastic.
- **Shower Valve:** 1" IPS brass stay-open ball valve with stainless steel actuating arm and stainless steel pull rod.
- **Spread Head Assembly:** Two GS-Plus spray heads. Each spray head has "flip top" dust cover, internal flow control and filter to remove impurities from water.
- **Bowl:** 11-12" stainless steel
- **Eyewash Valve:** 1/2" IPS brass stay-open ball valve with flag handle
- **Pipe and Fittings:** Schedule 40 galvanized steel with orange polyethylene covers for high visibility and corrosion resistance.
- **Supply:** 1-1/4" IPS female top inlet
- **Waste:** 1-1/4" IPS female outlet

SS909.....FLOOR MOUNTED

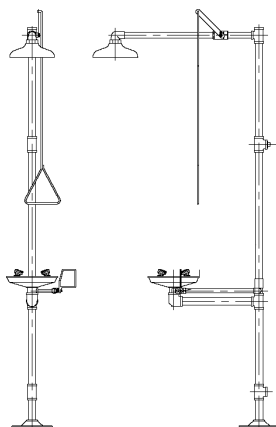

SSBF909.....FLOOR MOUNTED

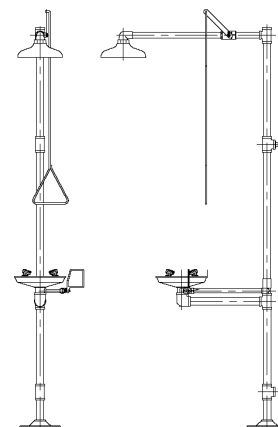

SSBF909PCC.....Polished Chrome Plated Brass
SSBF94.....Stainless Steel Construction

Note: All units supplied with ANSI compliant identification sign.